

## Standard Equipment /Optional Equipment

### Standard Equipment

Narrow chassis width 820mm  
 Key switch or PIN Code access  
 Multifunction coloured display as well as hourmeter, maintenance indication, battery discharge indicator and internal fault code indication  
 Power assisted steering  
 Automatic speed reduction when cornering  
 ECO-Mode with up to 12% energy savings  
 3 kW AC motor (maintenance free)  
 Drive wheel position mentioned in display

CAN bus technology  
 Lateral battery change 3PzS available with an ergonomic battery un/locking with lever & rollers (l2=1037mm)  
 Overhead guard  
 Soft landing on forks  
 Drive wheel Polyurethane  
 Single load wheel Polyurethane  
 Width over fork carriage: 560mm  
 Fork carriage length: 1150mm  
 Protection -10°C

### Optional Equipment

Drive wheels: cushion rubber, synthetic cushion rubber non marking, wet grip  
 Load wheels: tandem polyurethane, tandem polyurethane greasable  
 Lateral battery change 4PzS available with ergonomic battery un/locking with lever & rollers (l2=1112mm)  
 Leather seat & seat heating  
 Different Standard and Duplex masts with maximum lift height 2344mm  
 Load backrests with h=100mm  
 Floor compensator  
 Speed reduction if forks lowered

Mast Protection: polycarbonate, steel mesh  
**Linde Connected Solutions:**  
 ac:access control (PIN or RFID Dual), an: usage analysis and dt: crash detection  
 Flashing beacon  
 Support Clipboard DIN A4 & panoramic mirror  
 Support data terminal incl. power supply cable 24V  
 Mobile or Fixed battery stand  
 Automatic battery watering system  
 Cold store protection -35°C

#### Other options available on request

#### Li-ION Batteries

fits in 4 PzS SL compartment : 4,5kWh-9kWh (205Ah-410Ah) includes battery housing extra weight

#### Li-ION charger

optimized 24V-Charger v255: full charging time 1h30min (4,5kWh) and 2h40min (9,0kWh)

#### Li-ION

Rapid Full Charge  
 Opportunity Charging  
 Rapid Intermediate Charging  
 Maintenance Free  
 Extended Lifetime  
 Efficient performance in Cold Stores  
 Side Plug available



## Seated Double Pallet Stacker Capacity 1,200 kg D 12 R

Series 1164

Linde Material Handling

### Safety

High productivity combined with safety. The operator's body always remains within the chassis contours. An overhead guard provides additional protection. A dead-man foot switch actuates an electromagnetic brake on the drive wheel for impressively smooth and rapid stopping performance when required.

### Performance

One of the truck's many is its highly efficient productivity performance. The compact and powerful 3 kW AC drive unit enables precise manoeuvring, with speeds up to 10 km/h. With capacities up to 2,000 kg, the Linde Seated Double Stacker is designed to load/unload and or transfer two double-stacked pallets simultaneously. It can also be used as a normal stacker to store and retrieve 1,200 kg loads in narrow aisles.

### Comfort

The 90° seating position incorporating a padded armrest provides the operator with an ergonomic work station and effortless access to all operating controls. Three independent seat adjustments are complemented by an adjustable floorplate to suit each operator's preferences

## Features

#### Ergonomics

- Ergonomic operator's compartment with fabric or leather seat available incorporating three independent adjustments
- Heated seat available as an option
- Padded hand grip for easy access and an adjustable floor plate to suit individual operator's
- 90° Side-stance seating posture ensures excellent visibility in both directions of travel
- Overhead guard design provides optimum visibility



#### Lifting systems

- Lift control provides accurate lifting as well as smooth, quiet operation
- Soft landing on forks protects the load when lowering
- Initial lift independent of main lift
- Max. lift height up to 2344mm
- Max. load capacity in Stacker use : 1,200kg on load arms
- Max. load capacity when Double-Stacking : 1000kg on forks/1000kg

#### Handling

- Chassis width b1= 820mm
- Small l2 dimension = 1037mm
- High maneuverability when operating in lorries or confined spaces
- High seated position for good visibility
- Stable 4 point configuration
- Pallet stop for fast, efficient stacking of two pallets

#### TipControl®

- Traction, lift controls, initial lift and horn grouped in one single ergonomic unit
- Enables intuitive, fatigue-free operation of all controls
- Height adjustable hand support

#### Drive control and settings

- Steering effort adjusts automatically relative to speed and turning radius
- Speed is automatically reduced in relation to the steering angle
- Speed profiles available
- ECO-Mode up to 12% energy savings to finish shift with low battery status



#### Workstation

- Multifunctional instrument display with a user-friendly menu structure
- Truck access control by PIN code or ignition key
- Support clipboard DIN A4, flashing beacon available as options
- Emergency isolator located for instant actuation



#### Comprehensive energy solutions

- 24V batteries : capacities from 345 Ah (3PzS) to 500 Ah (4PzS)
- Standard Lateral change including rollers inside the battery compartment to aid battery change
- Lever initiates battery change preventing direct contact
- Li-ION batteries with 4,5kWh(205Ah) and 9,0kWh(410Ah)
- Fast full charge in 1h30min with optimized charger



#### AC drive motor

- Powerful, 3 kW drive motor
- Moisture and dust proof maintenance-free, AC drive motor
- Gradient performance of max. 15% (laden)
- No roll back on gradient starts
- High torque motor negotiates loading docks with ease

Linde Material Handling

Linde Material Handling | 5 Distillers Place | Huntingwood NSW 2148  
 Phone 1300 135 463 | www.lindemh.com.au

# Technical Data according to VDI 2198

Characteristics	1.1	Manufacturer	LINDE
	1.2	Manufacturer's type designation	<b>D12R</b>
	1.2a	Series	1164-01
	1.3	Power unit	Battery
Weights	1.4	Operation	Seat
	1.5	Load capacity/Load	Q (t) 1.2 / 2.0 <sup>1)2)</sup>
	1.6	Load centre distance	c (mm) 600
Dimensions	1.8	Axle centre to fork face	x (mm) 950 (835) <sup>3)4)</sup>
	1.9	Wheelbase	y (mm) 1824 (1709) <sup>3)4)</sup>
	2.1	Service weight	(kg) 1451 <sup>5)6)</sup>
	2.2	Axle load with load, front/rear	(kg) 1402 / 2049 (1267 / 2184) <sup>5)7)7)</sup>
	2.3	Axle load without load, front/rear	(kg) 992 / 459 <sup>5)6)</sup>
	3.1	Tyres rubber, SE, pneumatic, polyurethane	V+P/P <sup>8)9)</sup>
	3.2	Tyre size, front	Ø 254 x 102
	3.3	Tyre size, rear	Ø 85 x 85 (Ø 85 x 60) <sup>10)</sup>
	3.4	Auxiliary wheels (dimensions)	Ø 140 x 50
	3.5	Wheels, number front/rear (x = driven)	1x + 2 / 2 (1x + 2 / 4) <sup>10)</sup>
Performance	3.6	Track width, front	b10 (mm) 541 <sup>9)</sup>
	3.7	Track width, rear	b11 (mm) 380 <sup>9)</sup>
	4.2	Height of mast, lowered	h1 (mm) 1665 <sup>9)</sup>
	4.3	Free lift	h2 (mm) 150 <sup>9)</sup>
	4.4	Lift	h3 (mm) 2344 <sup>9)</sup>
	4.5	Height of mast, extended	h4 (mm) 2864 <sup>9)</sup>
	4.6	Initial lift	h5 (mm) 125
	4.7	Height of overhead guard (cabin)	h6 (mm) 2260
	4.10	Height of reach legs	h8 (mm) 80 <sup>11)</sup>
	4.15	Height, lowered	h13 (mm) 86 <sup>11)</sup>
	4.19	Overall length	l1 (mm) 2187 <sup>9)</sup>
	4.20	Length to fork face	l2 (mm) 1037 <sup>9)</sup>
	4.21	Overall width	b1/b2 (mm) 820 <sup>9)</sup>
	4.22	Fork dimensions DIN ISO 2331	s/e/l (mm) 55 x 180 x 1150 <sup>12)</sup>
	Drive	4.24	Width of fork carriage
4.25		Fork spread	b5 (mm) 560 <sup>9)</sup>
4.26		Distance between wheel arms/loading surfaces	b4 (mm) 255 <sup>9)</sup>
4.32		Ground clearance, centre of wheelbase	m2 (mm) 20 <sup>13)</sup>
4.34.1		Aisle width for pallets 1000 x 1200 crossways	Ast (mm) 2814 (2834) <sup>3)14)</sup>
4.34.2		Aisle width with pallet 800 x 1200 along forks	Ast (mm) 2684 (2754) <sup>3)14)</sup>
4.35		Turning radius	Wa (mm) 2012
5.1		Travel speed, with/without load	(km/h) 10 / 10 <sup>15)</sup>
5.2		Lifting speed, with/without load	(m/s) 0.107 / 0.174 (0.034 / 0.07) <sup>3)16)</sup>
5.3		Lowering speed, with/without load	(m/s) 0.377 / 0.394 (0.084 / 0.084) <sup>3)16)</sup>
5.8	Maximum climbing ability, with/without load	(%) 15.0 (10.0) / 20.0 <sup>1)</sup>	
5.9	Acceleration time, with/without load	(s) 6.1 / 4.8	
5.10	Service brake	Electro-magnetic	
Drive	6.1	Drive motor rating S2 60 min	(kW) 3
	6.2	Lift motor rating at 53 15%	(kW) 2.2
	6.3	Battery according to DIN 43531/35/36 A,B,C,no	43 535 / B
	6.4	Battery voltage/rated capacity (5h)	(V)/(Ah) 24 / 345/375
	6.5	Battery weight (± 5%)	(kg) 287
	6.6	Power consumption according to VDI cycle	(kWh/h) 1.08
	6.7	Turnover output	(t/h) 48.0
	6.8	Energy consumption at turnover output	(kWh/h) 1.7
	8.1	Type of drive unit	LAC
	10.7	Sound pressure level LpAZ (at the driver's seat)	(dB(A)) 69 <sup>16)</sup>

1) Load distribution e.g. 1000 kg on the forks, 1000 kg on the fork arms. Total load max. 2000 kg.)  
 2) 2000 kg on the load arms (initial lift)  
 3) Figures in parenthesis with initial lift  
 4) (± 5 mm)  
 5) Figures with battery, see line 6.4/6.5.  
 6) (± 10%)  
 7) Load: 2000 kg  
 8) Drive Wheel Option: rubber non marking, Polyurethane and wet grip  
 9) Solid rubber + polyurethane / polyurethane  
 10) Figures in parenthesis with tandem load wheels.  
 11) (-0/+5 mm)  
 12) Reach legs 75x150x1115  
 13) (± 2 mm)  
 14) Including a 200 mm (min.) operating aisle clearance.  
 15) (± 5%)  
 16) (± 2.5)

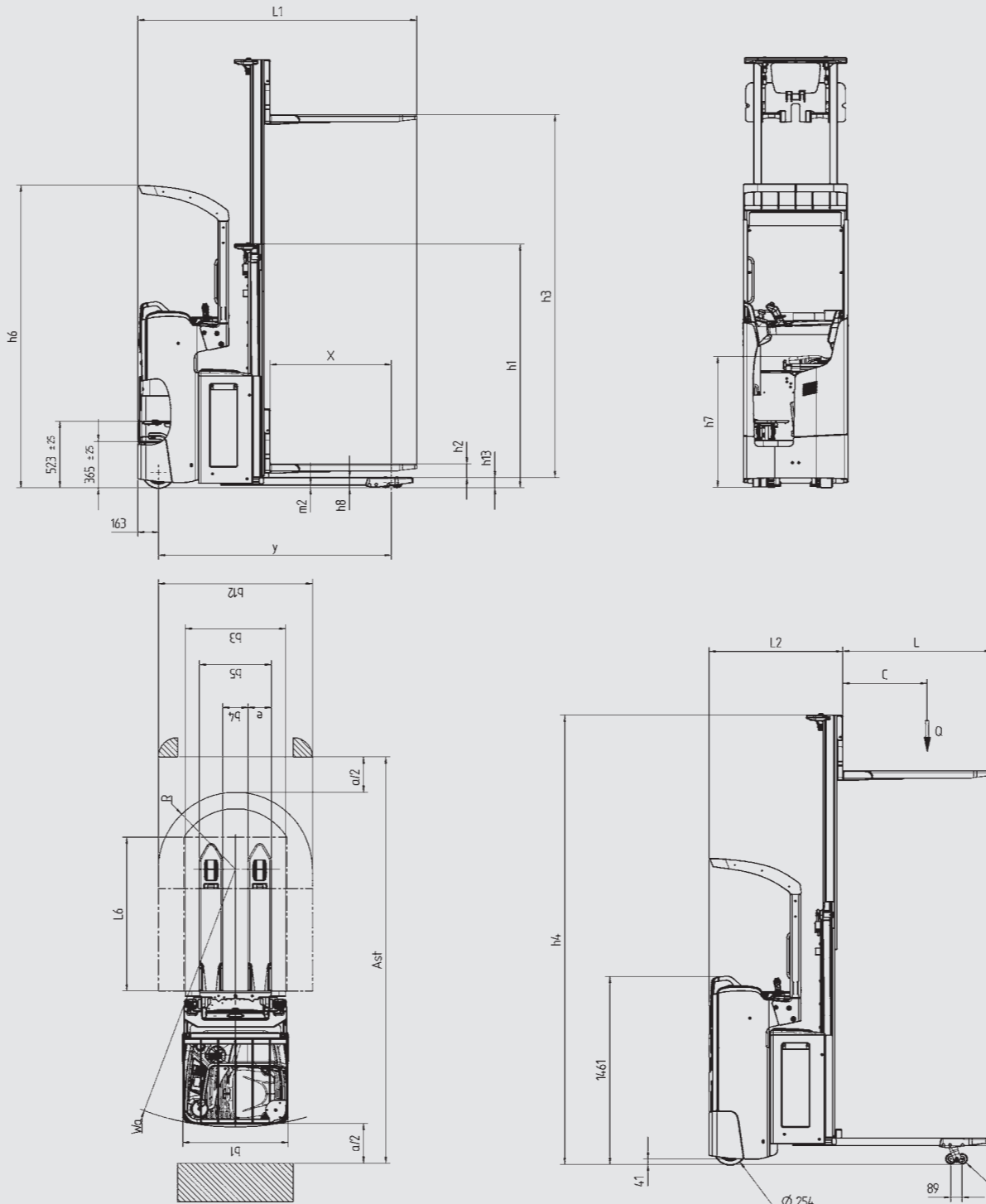

Mast D12 R (in mm)	1844 S	2344 S	1844 D	2344 D	
Lift	h3	1844	2344	1844	2344
Lift + fork height	h3+h13	1930	2430	1930	2430
Height, mast lowered	h1	1415	1665	1415	1665
Closed height (with free lift at 150 mm)	h1#	1490	1740	-	-
Height, mast extended	h4	2364	2864	2364	2864
Free lift	h2	150	150	895	1145





# SEATED DOUBLE PALLET STACKER D12 RW

**CAPACITY 1200 KG | SERIES 1164**

## Safety

High performance combined with safety. The three independent braking systems and a four point configuration ensures inherent safety and stability. The operator is always safely within the chassis contour. The overhead guard provides additional protection.

## Performance

The compact and powerful 3 kW AC drive unit enables precise maneuvering with speeds up to 10 km/h. With capacities up to 2000 kg, the Linde Seated Double Stacker is designed to transfer two double-stacked pallets simultaneously. When used as a double stacker the speed can be further optimized thanks to the new Speed Management option.

## Comfort

The 90° sitting position provides excellent all-round visibility over the environment. The spacious operator's compartment and the padded armrest offer a stress-free working environment for optimum efficiency and productivity. All the operating controls incorporated in

the console are easily accessible. The sitting position and the floorplate are adjustable to suit every operator's preferences.

## Reliability

Rugged construction and the use of tried and tested components ensure this is a truck that can be relied on. Motor, sub-components and electronics are all protected within the robust chassis structure. A pallet stop ensures durability of lifting units. These features guarantee a longer operating life; delivering safe, efficient, and productive load handling.

## Service

Efficiency at work and efficiency in servicing with cost effective maintenance routines. Easy access to all components and maintenance-free technology also play their part in increasing truck up-time and availability. CAN bus connectivity provides a computerised diagnostic system for rapid analysis to ensure maintenance intervals are also minimized.

# TECHNICAL DATA

## ACCORDING TO VDI 2198

Characteristics	1.1	Manufacturer		LINDE
	1.2	Model design		<b>D12 RW</b>
	1.3	Power unit		Battery
	1.4	Operation		Seat
	1.5	Load capacity / Load	Q (t)	1.2 / 2.0
	1.6	Load centre distance	c (mm)	600
	1.8	Axle centre to fork face	x (mm)	950 (835)
	1.9	Wheelbase	y (mm)	1828 (1713)
	Weight	2.1	Service weight	(kg)
2.2		Axle load with load, front / rear	(kg)	1461 / 2100 (1326 / 2235)
2.3		Axle load without load, front / rear	(kg)	1052 / 509
Wheels and types	3.1	Tyres rubber, SE, pneumatic, polyurethane		V + P / P
	3.2	Tyre size, front		Ø 254 x 102
	3.3	Tyre size, rear		Ø 85 x 60
	3.4	Auxiliary wheels (dimensions)		Ø 140 x 50
	3.5	Wheels, number front / rear (x = driven)		1x + 1 / 4
	3.6	Track width, front	b <sub>10</sub> (mm)	699
	3.7	Track width, rear	b <sub>11</sub> (mm)	380
Dimensions	4.2	Height of mast, lowered	h <sub>1</sub> (mm)	1665
	4.3	Free lift	h <sub>2</sub> (mm)	150
	4.4	Lift	h <sub>3</sub> (mm)	2344
	4.5	Height of mast, extended	h <sub>4</sub> (mm)	2864
	4.6	Initial lift	h <sub>5</sub> (mm)	125
	4.7	Height of overhead guard (cabin)	h <sub>6</sub> (mm)	2260
	4.8	Height of seat / stand on platform	h <sub>7</sub> (mm)	1166
	4.10	Height of reach legs	h <sub>8</sub> (mm)	80
	4.15	Height, lowered	h <sub>13</sub> (mm)	86
	4.19	Overall length	l <sub>1</sub> (mm)	2187
	4.20	Length to fork face	l <sub>2</sub> (mm)	1037
	4.21	Overall width	b / b <sub>2</sub> (mm)	820
	4.22	Fork dimensions DIN ISO 2331	s / e / l (mm)	71 x 180 x 1150
	4.24	Width of fork carriage	b <sub>3</sub> (mm)	780
	4.25	Fork spread	b <sub>5</sub> (mm)	560
	4.26	Distance between wheel arms / loading surfaces	b <sub>4</sub> (mm)	255
	4.32	Ground clearance, centre of wheelbase	m <sub>2</sub> (mm)	20
	4.34.1	Aisle width for pallets 1000 x 1200 crossways	A <sub>31</sub> (mm)	2823 (2843)
	4.34.2	Aisle width with pallet 800 x 1200 along forks	A <sub>31</sub> (mm)	2693 (2763)
	4.35	Turning radius	W <sub>a</sub> (mm)	2021
Performance	5.1	Travel speed, with / without load	(km / h)	10 / 12
	5.2	Lifting speed, with / without load	(m / s)	0.107 / 0.174 (0.034 / 0.07)
	5.3	Lowering speed, with / without load	(m / s)	0.377 / 0.394 (0.084 / 0.084)
	5.8	Maximum climbing ability, with / without load	(%)	17.0 (16.0) / 20.0
	5.9	Acceleration time, with / without load	(s)	5.9 / 4.7
	5.10	Service brake		Electro-magnetic
Drive	6.1	Drive motor rating S2 60 min	(kW)	3
	6.2	Lift motor rating at S3 15 %	(kW)	2.2
	6.3	Battery according to DIN 43531 / 35 / 36 A, B, C, no		43 535 / 3 PzS
	6.4	Battery voltage / rated capacity (5h)	(V) / (Ah)	24 / 345 / 375
	6.4.a	Battery energy content	(kWh)	7.2
	6.5	Battery weight (± 5%)	(kg)	287
	6.6	Power consumption according to VDI cycle	(kWh / h)	1.1
	6.7	Turnover output	(t / h)	45.6
	6.8	Energy consumption at turnover output	(kWh / h)	1.68
	8.1	Type of drive unit		LAC
10.7	Sound pressure level LpAZ (at the driver's seat)	(dB(A))	62	

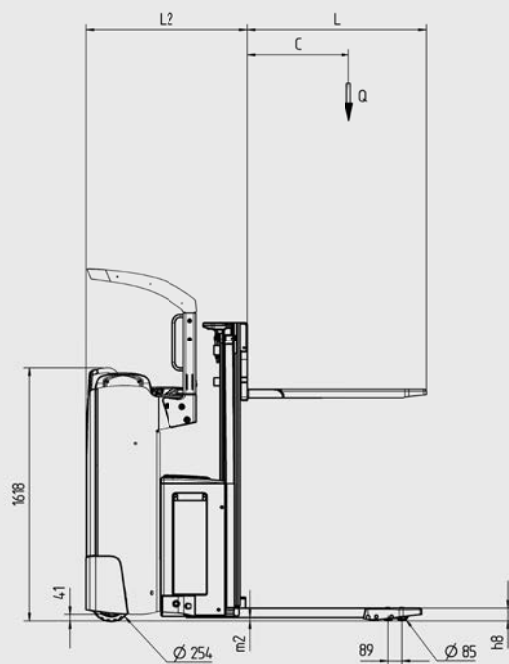
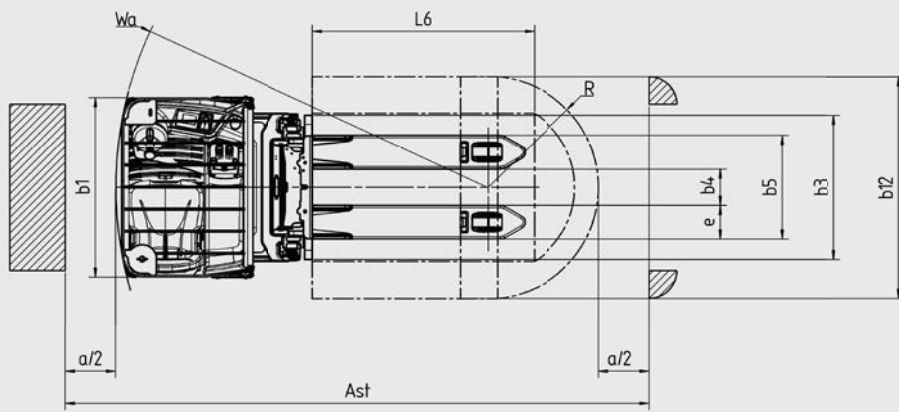
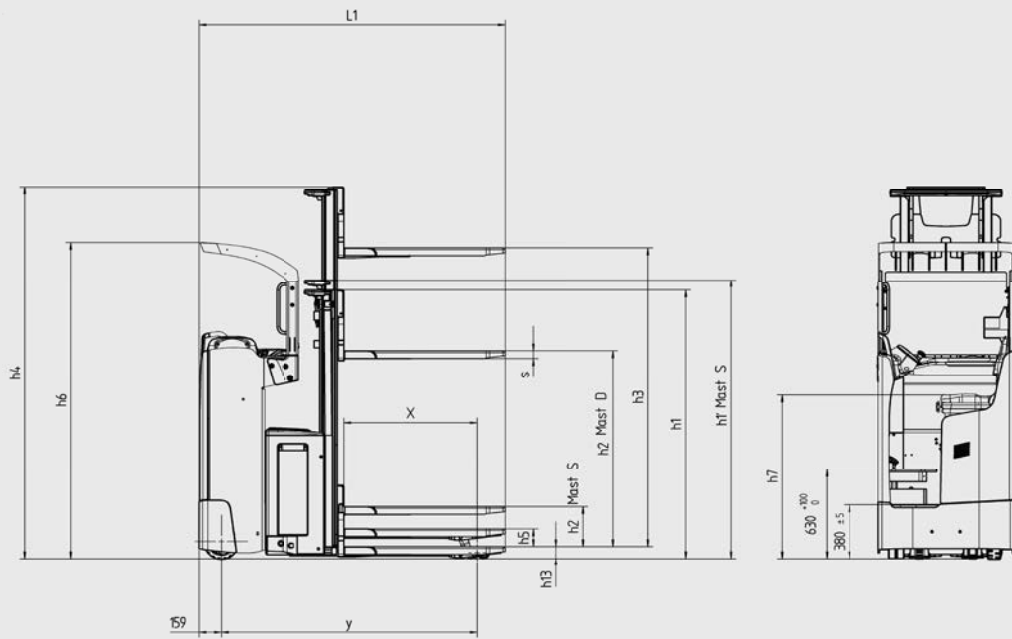

# STANDARD EQUIPMENT / OPTIONAL EQUIPMENT

## STANDARD EQUIPMENT

Chassis width 970 mm
Key switch or PIN Code access
Multifunction coloured display with hour meter, maintenance indication, battery discharge indicator and internal fault code indication
Automatic speed reduction
ECO-Mode with up to 12% energy savings
3kW AC motor (maintenance free)
CAN bus technology
Overhead guard
Soft landing on forks
Drive wheel Polyurethane
Tandem load wheel Polyurethane
Lateral battery change 3 PzS available with ergonomic battery un/locking with lever and rollers ( $l_2 = 1037$ mm)
Width over fork carriage: 560 mm
Fork carriage length: 560/1150/55 mm
Protection -10° C

## OPTIONAL EQUIPMENT

Drive wheels: cushion rubber, synthetic cushion rubber non marking, wet grip
Load wheels: tandem polyurethane greasable
Lateral battery change 3 PzS/4 PzS available with an ergonomic battery un/locking with lever and rollers ( $l_2 = 1112$ mm)
Leather seat and seat heating
Additional head support
Different Standard and Duplex masts with maximum lift height 3244 mm
Load backrests with $h = 1000$ mm
Mast Protection: polycarbonate, steel mesh
Flashing beacon
Support Clipboard DIN A4 and panoramic mirror
Support data terminal incl. power supply cable 24V
Mobile or Fixed battery stand
Cold store protection -35° C
Blue spot
Speed management
Other options available on request

### Linde Connected Solutions:

ac: access control (PIN or RFID Dual),  
an: usage analysis and dt: crash detection

Data transfer Online

Data transfer WIFI

Bluetooth USB Stick

### Li-ION technology:

4PzSL compartment: 4.5kwh - 9Kwh (205Ah - 410Ah)

### Li-ION charger:

24V-Charger v255: 4.5 kWh (full charging time 1h30min) - 9.0kWh (2h40min)

## MAST TABLES

Mast 1.4 and 1.6 t (in mm)		1844 S	2344 S	2844 S	3244 S	1844 D	2344 D	2844 D	3244 D
Height, mast lowered	$h_1$	1415	1665	1915	2115	1415	1665	1915	2115
Closed height (with free lift at 150 mm)	$h_v$	1490	1740	1990	2190	/	/	/	/
Free lift	$h_2$	150	150	150	150	895	1145	1395	1595
Lift	$h_3$	1844	2344	2844	3244	1844	2344	2844	3244
Height, mast extended	$h_4$	2364	2864	3364	3744	2364	2864	3364	3764
Other masts on request S = Standard, D = Duplex, T = Triplex									



# FEATURES

## Lifting systems

- Precise, effortless fingertip control of all mast movements
- Soft landing on forks protects the load when lowering
- Initial lift independent of main lift
- Max. load capacity when Double-Stacking: 1000 kg on forks / 1000 kg



## Speed management

- Increased performance when used as double stacker
- Speed optimization of the truck is linked to the weight of the load on the free lift

## Handling

- Chassis width  $b_1 = 970$  mm
- High seated position for excellent visibility
- Stable 4 point configuration
- Pallet stop for fast, efficient stacking of two pallets

## Comprehensive energy solutions

- 24V batteries: capacities from 345 Ah (3PzS) to 500 Ah (4PzS)
- 24V high batteries: capacities from 420 Ah (3PzS) to 620 Ah (4PzS)
- Li-ION batteries with 4.5 kWh (205 Ah) and 9.0 kWh (410 Ah)

## Drive control and settings

- Compact steering wheel integrated into the console
- Traction speed automatically reduces in relation to the steering angle
- ECO-Mode up to 12% energy savings to finish shift with low battery status



## Workstation

- Multifunctional instrument display with easy ergonomic menu
- Truck access control by PIN code or ignition key
- Storage compartment for work gloves, writing utensils etc.
- Emergency isolator

## Ergonomics and sitting position

- 90° Side-stance seating posture ensures excellent visibility
- Padded armrest and easy access to all operating controls
- Three independent adjustments systems: backrest adjustable, length adjustable, weight adjustable for operator's comfort
- Adjustable floor plate

## Twin or single pedal

- Seamless and effortless forward/reverse selection provides outstanding traction control and places minimal demands on operator
- The left foot is safely protected within the chassis contours
- The operator is able to maintain high levels of efficiency and productivity

Subject to modification in the interest of progress. Illustrations and technical details could include options and not binding for actual constructions. All dimensions subject to usual tolerances.

Linde Material Handling

Linde Material Handling | 5 Distillers Place | Huntingwood NSW 2148  
Phone 1300 135 463 | [www.lindemh.com.au](http://www.lindemh.com.au)